

Palon S

Electromechanical spindle drive
for automatic bollards

**Rising time
just 2.5 seconds***



The areas of application for the Palon S are automatic bollard lowering devices for securing and blocking paths, parking spaces and work areas. Thanks to the integrated limit switches, the Palon S can be incorporated quickly without additional controls. Compared with hydraulic drive systems, it is especially environment-friendly as it does not require any oil.

made in
GERMANY

Features

- Low energy consumption
- Maintenance-free throughout service life
- Water-tight aluminium housing
- Integrated end position limit switch
- Direct parallel connection for several drives

Options

- Integrated heating
- Operation possible via uninterrupted supply voltage (USV) for safety-relevant applications
- End position feedback (non-isolated)
- Radio remote control

Types of fastening

- Articulated lug
- Threaded pin (piston end)
- Joint rod head (DIN 648)
- Flange attachment

* Depending on travel range

Technical specifications

Housing diameter (mm)	80
Rated voltage	230 V 1AC, 50 Hz
Rated current (A)	approx. 2.3
Power consumption (VA)	530
Adjusting force (N)	400
Stroke length (mm)	400, 500, 600
Stroke speed (mm/s)	approx. 200
Rising time (s)	approx. 2.5*
Limit switch	internal, adjustable
Capacitor	external
Piston rod	secured against rotation
Ingress protection (IP)	67
Temperature range (°C)	-10 to +60
Mounting position	Piston rod upwards
Brake	Integrated retaining brake
Fastening	Articulated lug, flange, threaded pin (piston end), joint rod head (DIN 648)
Housing material	Aluminium, anodised

* Depending on travel range

Variants

Variant	Feedback	Heater 230V	Circuit diagram
1	x	–	WS9303
2	x	x	
3	–	–	WS9403
4	–	x	

Dimensions table

Nominal size	Stroke length (mm)	Body dimension (mm)
1	400	882
2	500	982
3	600	1,082

Accessories

- Radio remote control
- Hand-held transmitter
- Heater

Fastening options

piston end

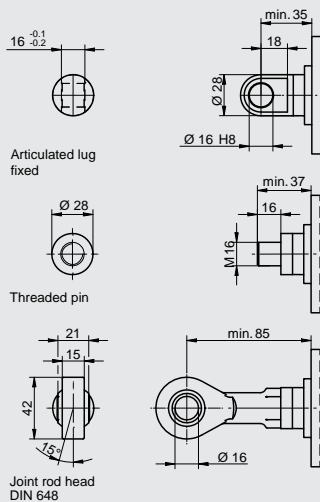

housing end

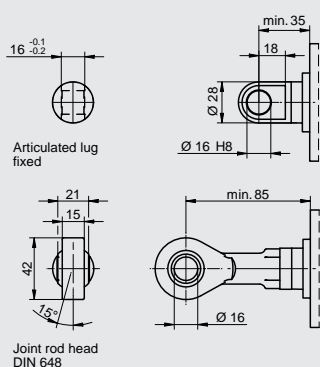

Plan of dimensions for 600 mm stroke length

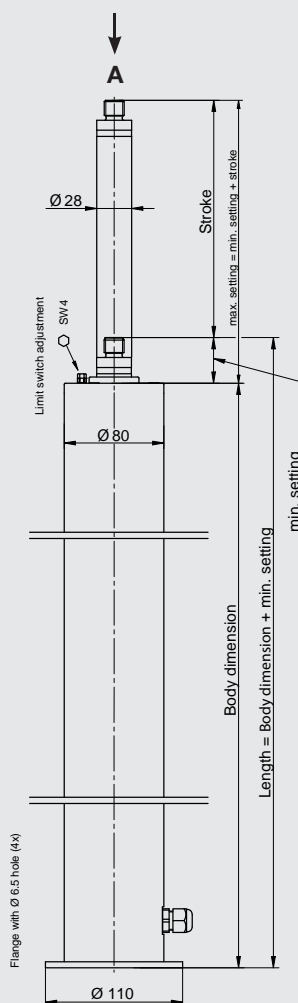

View A

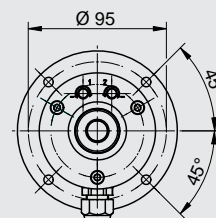

Please find further technical information on our website www.elero-linear.com in the category Service/Instructions.

elero GmbH Linear Drive Technology

Technical/Sales
Nassaeckerstrasse 11
07381 Poessneck/Germany
T +49 3647 4607-0
F +49 3647 4607-42

Order processing
Linsenhofer Strasse 65
72660 Beuren/Germany
T +49 7025 13-02
F +49 7025 13-290

info@elero-linear.de
www.elero-linear.com